

Soft Quad

Considerations:

- Narrow AP, Wide ML
- More comfortable for sitting
- Designed for geriatric amputees with low activity levels
- Designed for limbs with sufficient soft tissue coverage in a soft and/or flabby condition
- Does lack medial proximal stabilizing force
- Ischial weight-bearing socket with less pronounced ischial support area and Scarpa's triangle

Anterior View

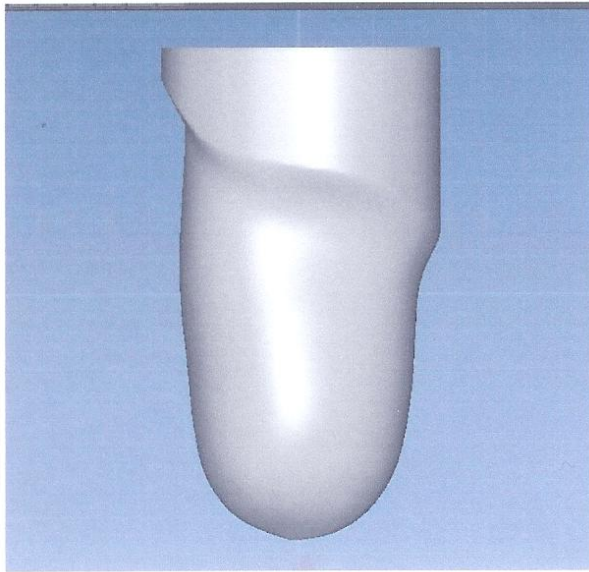

Posterior View

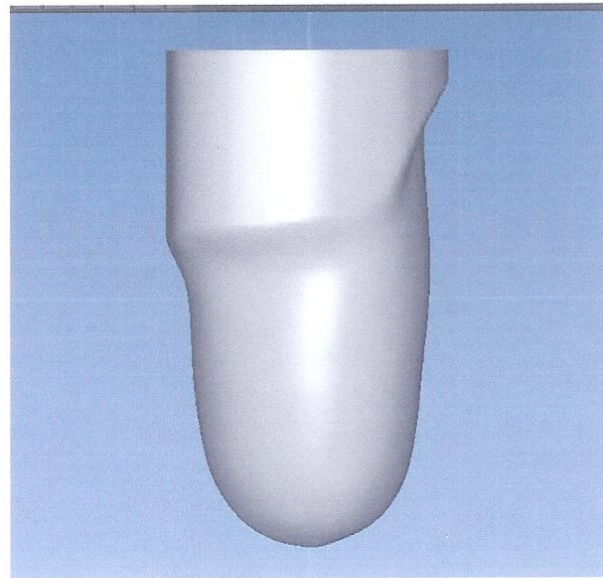

Medial View

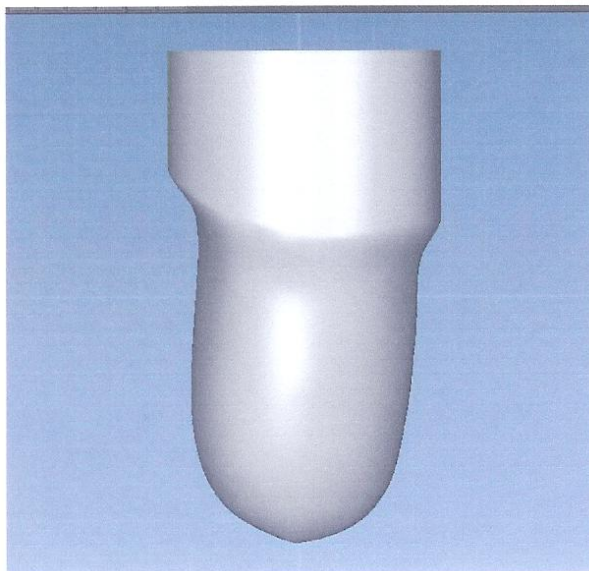

Lateral View

